

LIAISON PANNE /MUR  
Liaison panne / mur

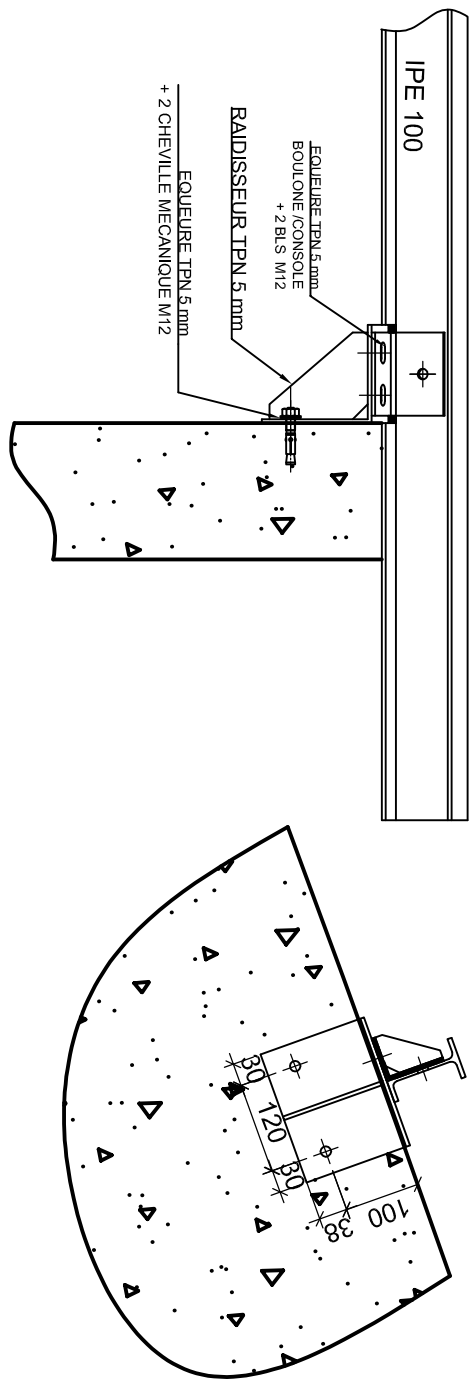

Ech: 1/10

LIAISON BUTON /MUR

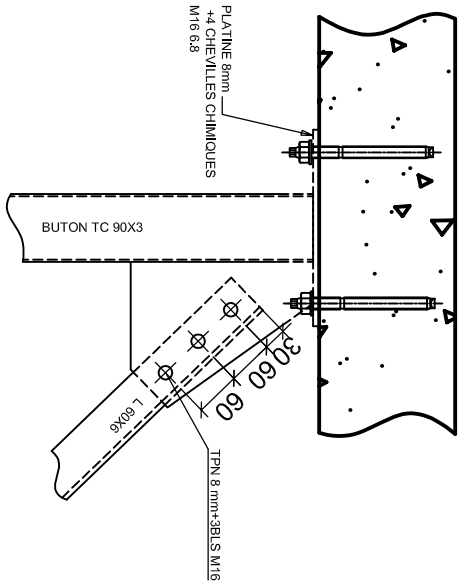
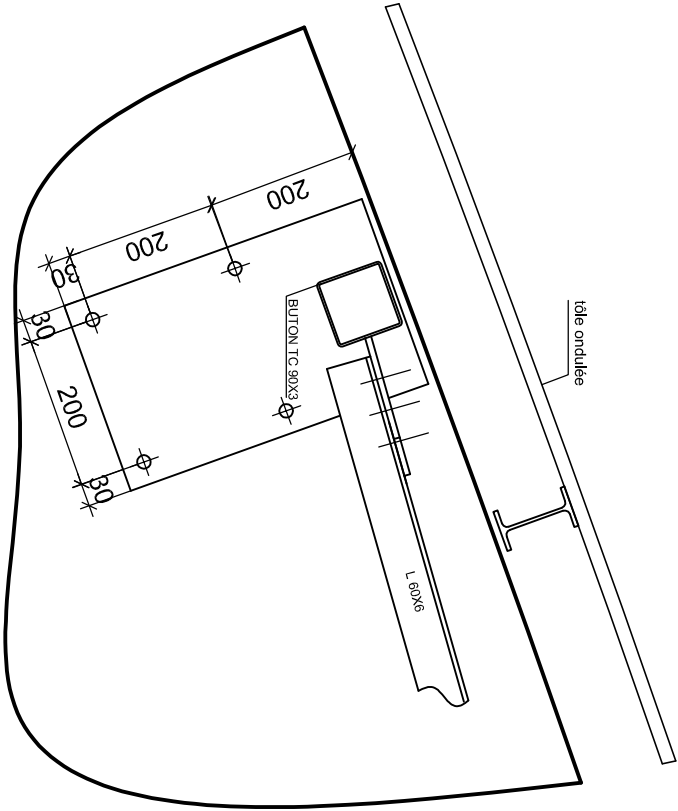

Ech: 1/10

LIAISONDIAGONALE  
EN PIED POTEAU

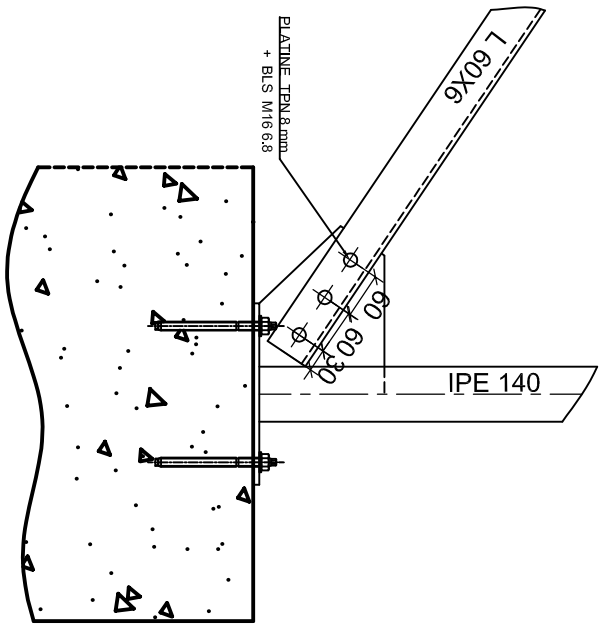

Ech: 1/10

LIAISON BUTON / ARBA IPE 200  
ET LIAISON POTEAU EN IPE 160

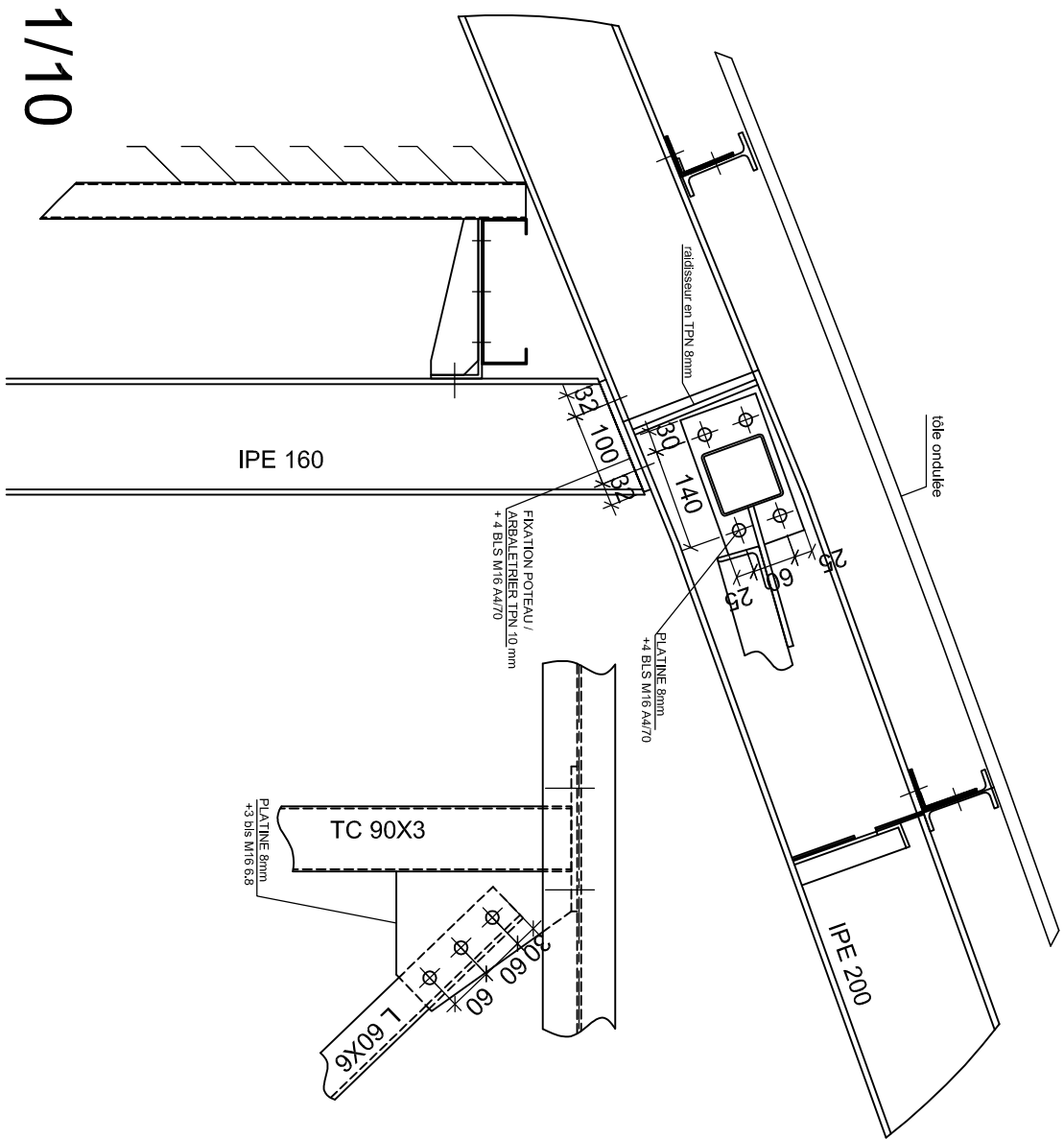

Ech: 1/10

ATTACHE PANNE / ARBA  
EN IPE 140

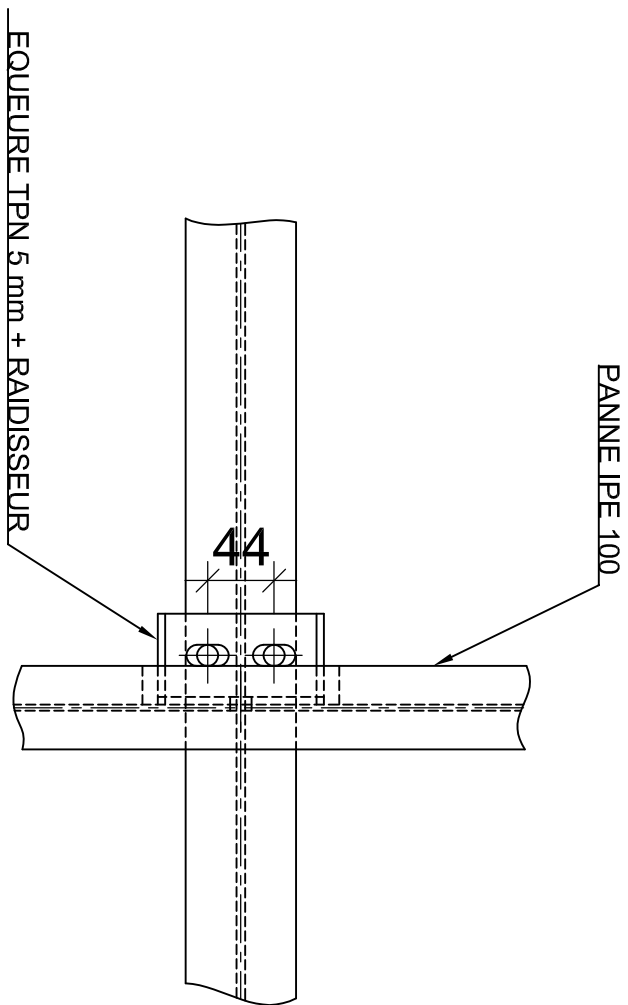
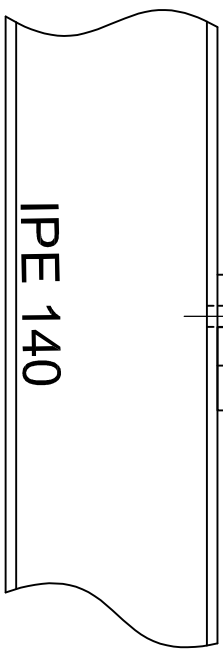

Ech: 1/5

ATTACHE PANNE / ARBA  
IPE 200

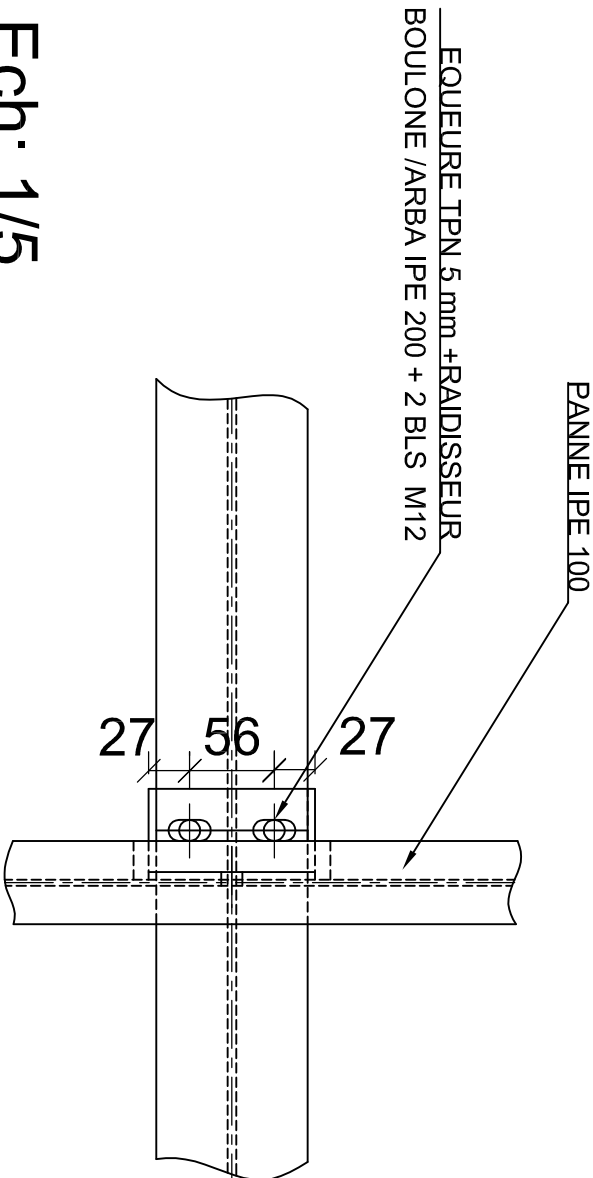
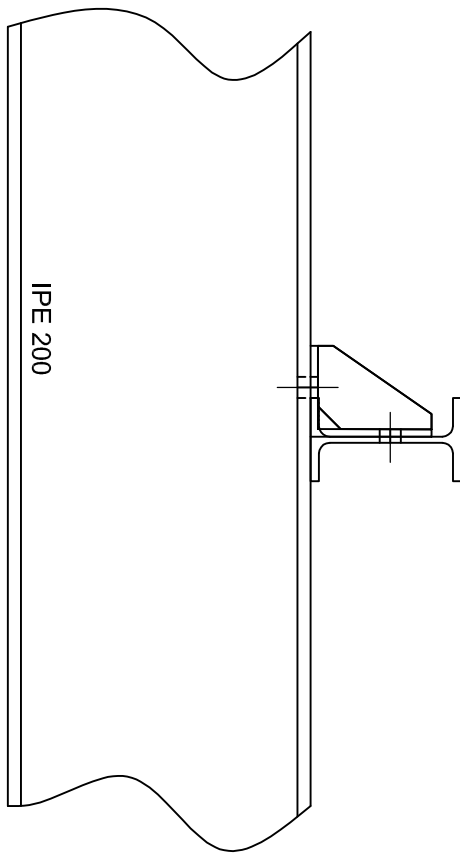

Ech: 1/5

DETAIL BRACON / ARBA EN IPE 200  
BRACON TOUTS LES 3 PANNES

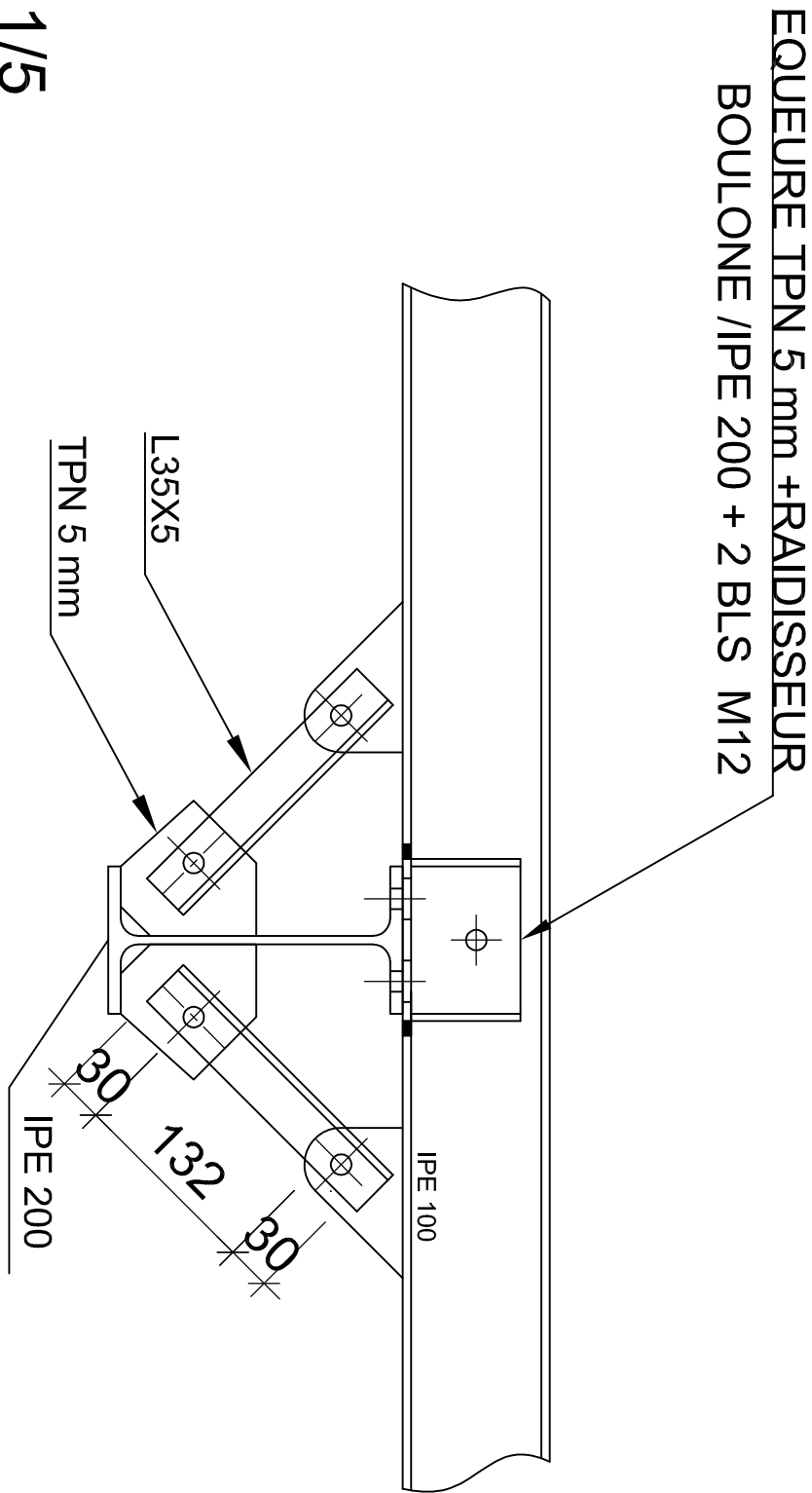

Ech: 1/5

LIAISON BUTON / ARBA EN IPE 140  
+ LIAISON POTEAU EN IPE 140

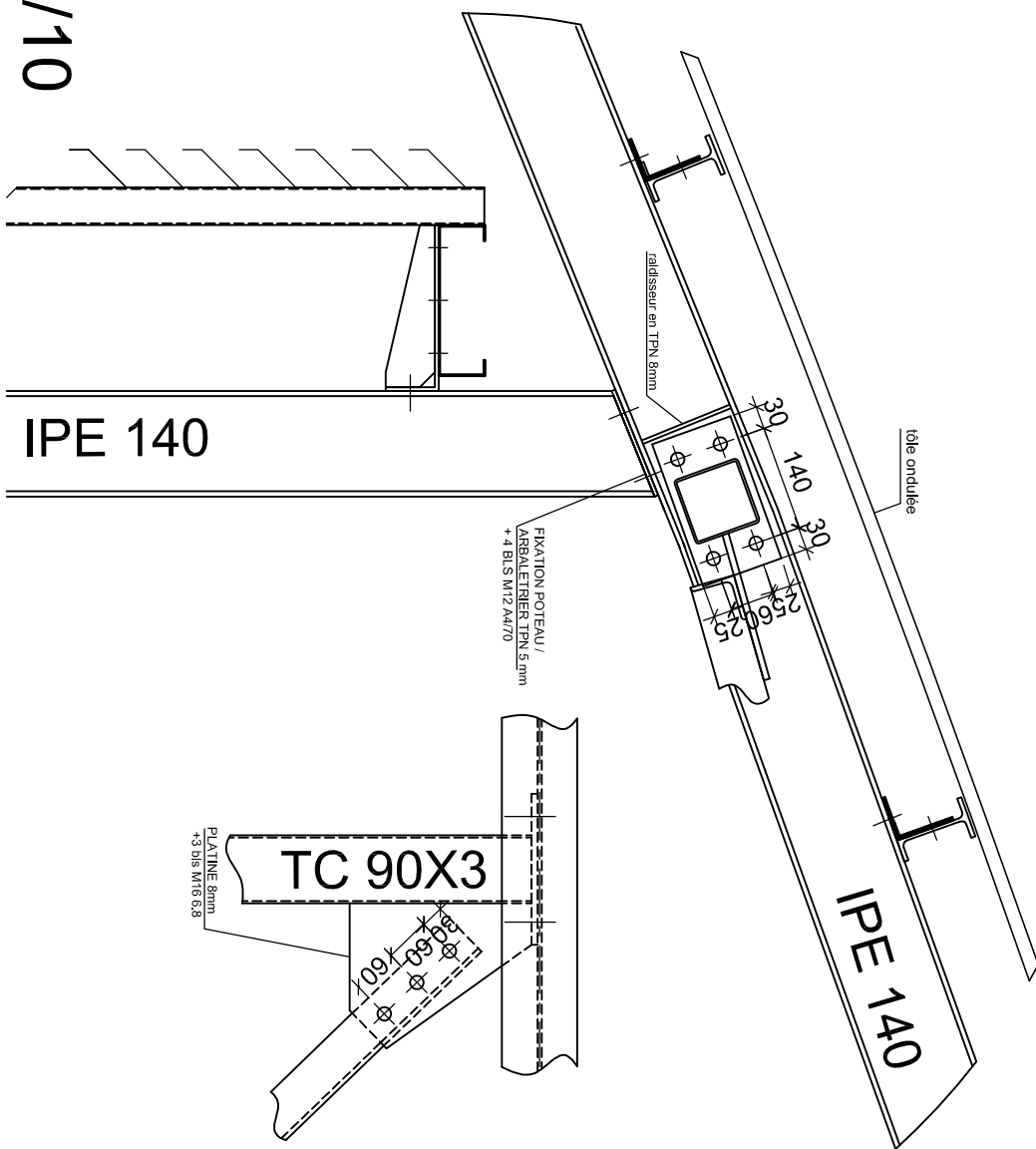

Ech: 1/10

LIAISON BUTON /ARBA EN IPE140  
+ LIAISON POTEAU TC 50X3

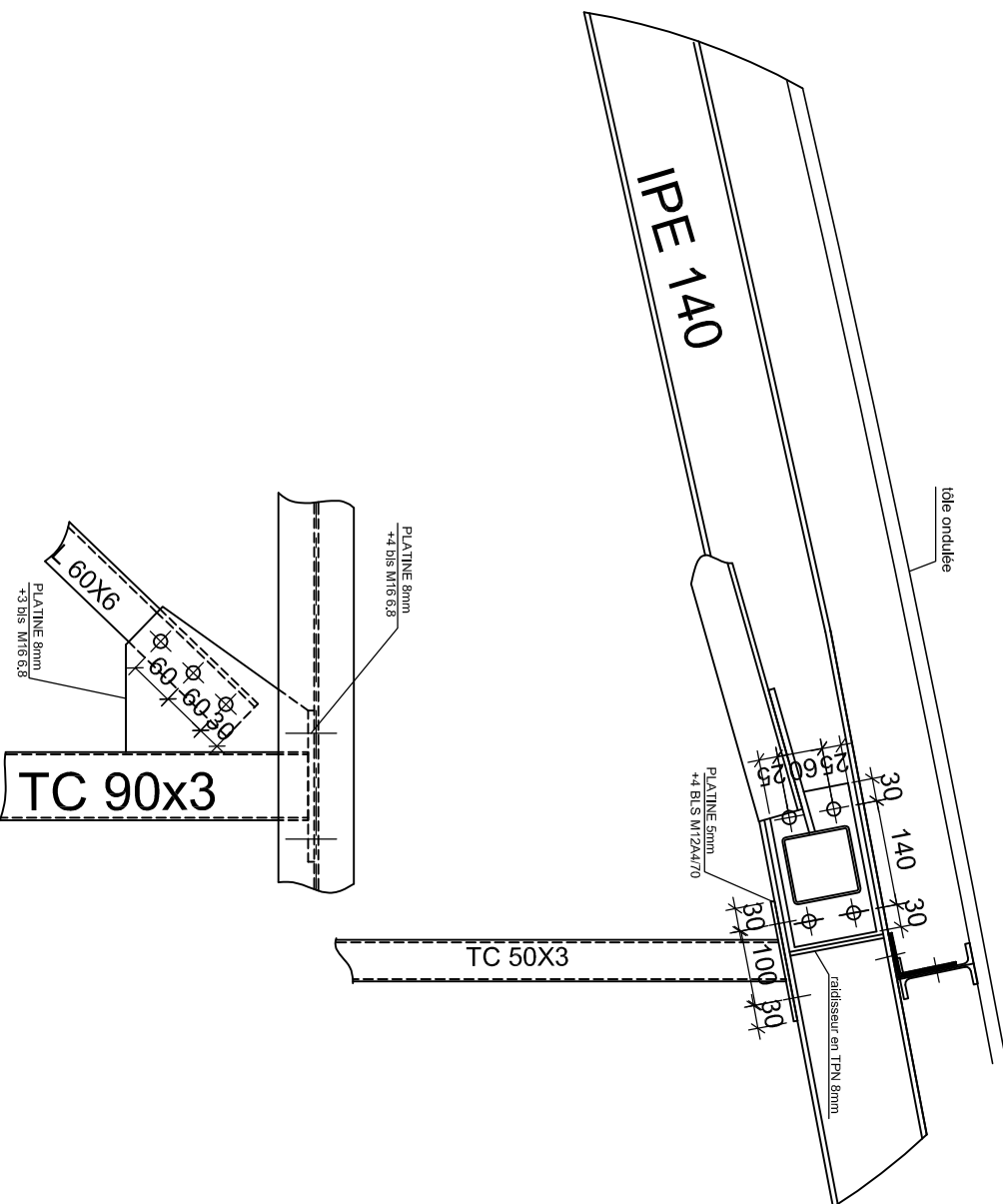

Ech: 1/10

DEPARTEMENT DE LA REUNION

COMMUNE DE SAINT PIERRE

R.S.M.A.R. QUARTIER SUACOT  
Construction de 2 bâtiments hébergements  
2ème tranche

Plan Charpente

Maitre d'Ouvrage :  
Service Militaire Adapté

Bureau de contrôle :  
-

Maitre d'Oeuvre :  
Direction des travaux infrastructure du RSMA-R

Entreprise charpente et couverture :  
B&M STRUCTURE  
PAE de la Mare  
lot 9 - Atelier n°65  
97438 Sainte-Marie

N°Plan : CH04

DOE

Date : 28/02/12Ech : .

Indice

Date

Modification



B&M Structure  
PAE de la Mare  
lot 9 - Atelier n°65  
97438 Sainte-Marie  
Fax : 0262 / 97 60 66